

## Written Comments Invited on Draft Cranford Regeneration Plan

Pursuant to section 34 of the Greater Christchurch Regeneration Act 2016 (“Act”), written comments are invited on the draft Cranford Regeneration Plan (“Plan”) that was developed pursuant to section 33 of the Act. The extent of the draft Plan area is shown in the following map:

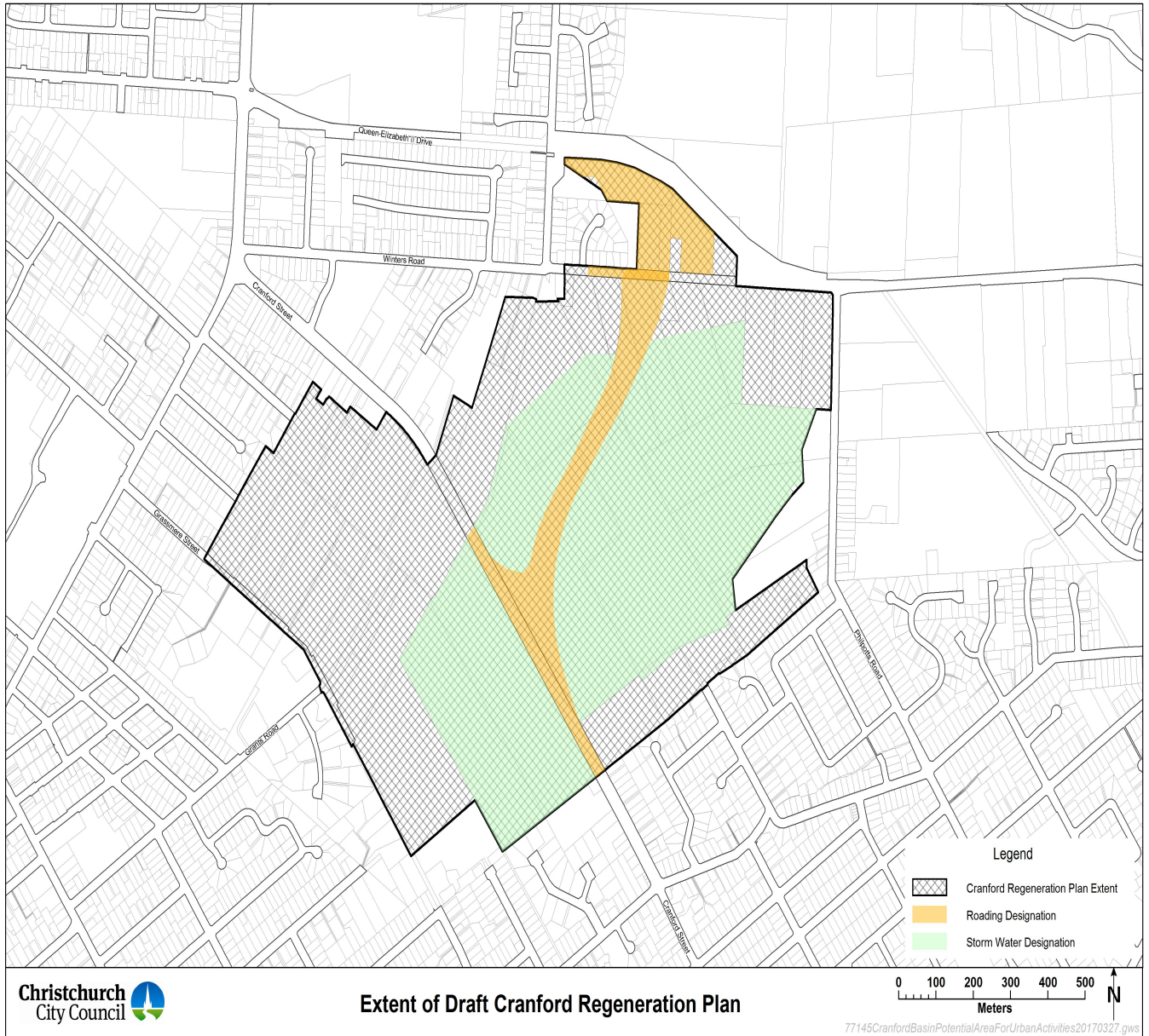

The objective of the draft Plan is to support the regeneration of greater Christchurch by:

- investigating the appropriateness of residential development at the edges of the Cranford Basin;
- providing for and, where possible, enhancing ecological values and Ngāi Tahu cultural values; and
- implementing a waterway and pedestrian and cycle connection network.

The draft Plan may amend the Canterbury Regional Policy Statement and the Christchurch District Plan, and any other statutory documents, pursuant to section 63 of the Act, necessary to facilitate residential development in the Papanui/St Albans area.

The draft Plan may be viewed on the Christchurch City Council website at [www.ccc.govt.nz/haveyoursay](http://www.ccc.govt.nz/haveyoursay) and copies are available for inspection at:

Civic Offices  
53 Hereford Street

Christchurch

Papanui Library  
35 Langdons Road  
Christchurch

Redwood Library  
339 Main North Road  
Christchurch

Council planners will also be available to answer questions or clarify content of the draft Plan at drop-in sessions to be held at the Papanui Street School Hall on Wednesday 5 April 2017 between 4.00pm and 6.00pm, and on Wednesday 12 April 2017 between 5.00pm and 7.00pm. These sessions are informal and do not include presentations.

A concise summary recording the views of the parties listed in section 29 of the Act (Canterbury Regional Council, Te Rūnanga o Ngāi Tahu, Ōtākaro Limited, Regenerate Christchurch, and Department of the Prime Minister and Cabinet) on a draft of the Plan may be viewed at [www.ccc.govt.nz/haveyoursay](http://www.ccc.govt.nz/haveyoursay) and copies are available for inspection at the addresses above.

Written comments on the draft Plan may be made to Christchurch City Council by no later than 2 May 2017 and should be emailed to [engagement@ccc.govt.nz](mailto:engagement@ccc.govt.nz) or posted to Cranford Regeneration Plan, Christchurch City Council, PO Box 73012, Christchurch 8154. Attention: Ivan Thomson.

Dated this 30th day of March 2017.

IVAN IAFETA, Chief Executive, Regenerate Christchurch.

2017-gs1527

---